

BSR ELECTRIC'S Augmented Reality APP

Short Overview and Introduction

In order to open the app, use the following link:

<https://apps.apple.com/de/app/bsr-electric/id1508215478>

or the QR code below:

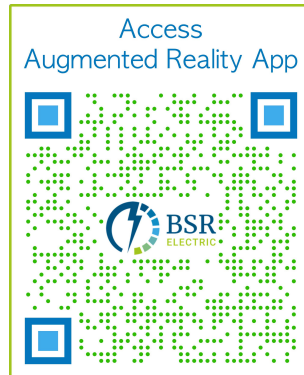



After opening the app, you can choose between displaying the content on the physical folding map (if you have it at hand) and displaying the objects on a surface such as a table.

Foldmap-Tracking

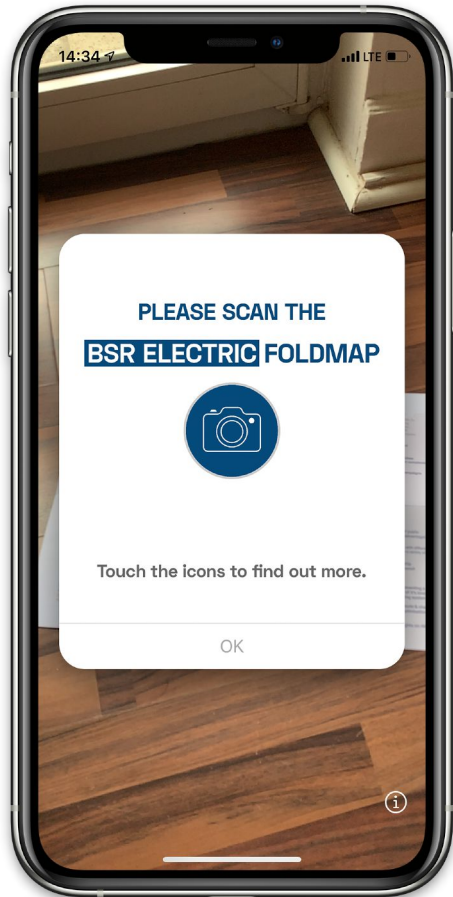

A pop-up indicates that Foldmap Tracking is selected and that you can scan the map with the camera.



Plane-Tracking

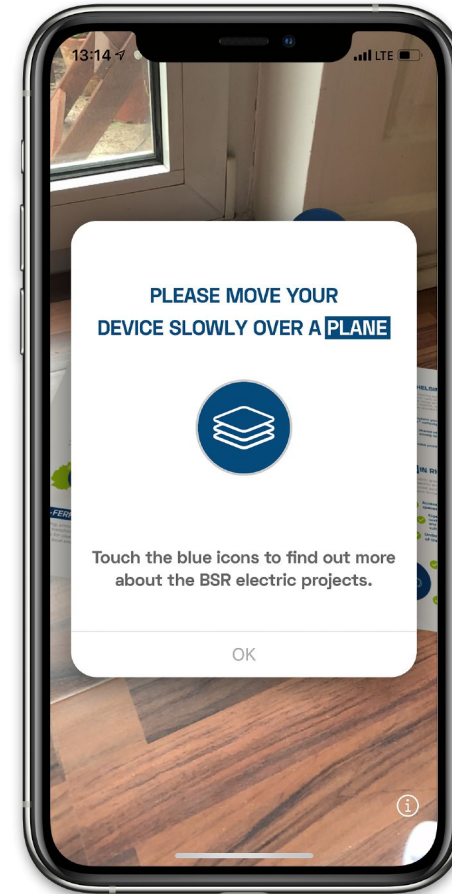

A pop-up indicates that plane tracking has been selected.





The 3D objects are shown.



Display of the 3D objects on the digital map. The map can be rotated and moved by using different touch gestures.

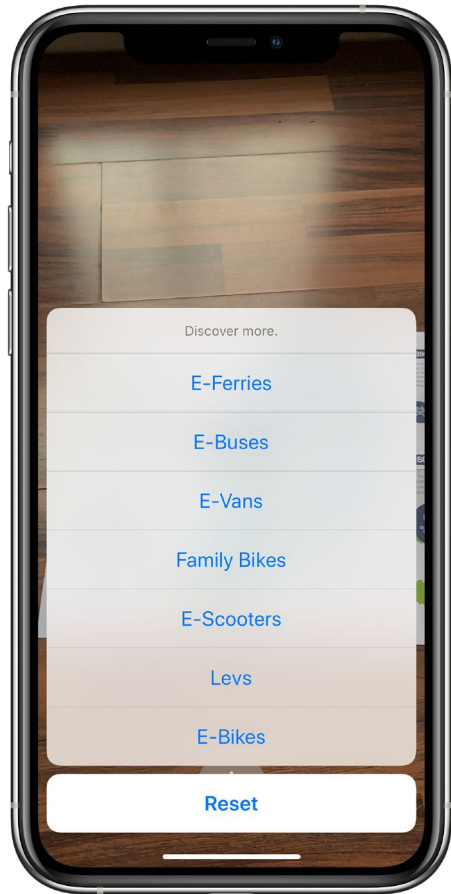

You can click on the Plus button to see the individual projects.

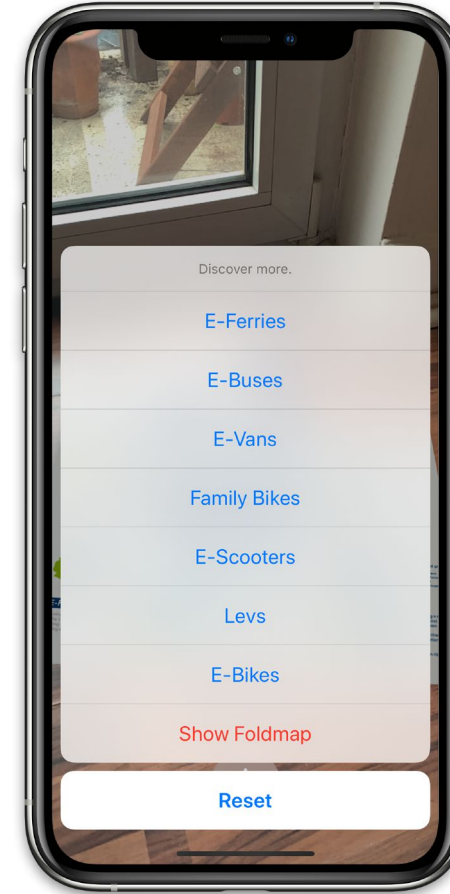

The projects can also be filtered here. In addition, the foldmap can also be displayed without 3D objects.



For example, the e-bus use case is shown here.



Display of the virtual map.

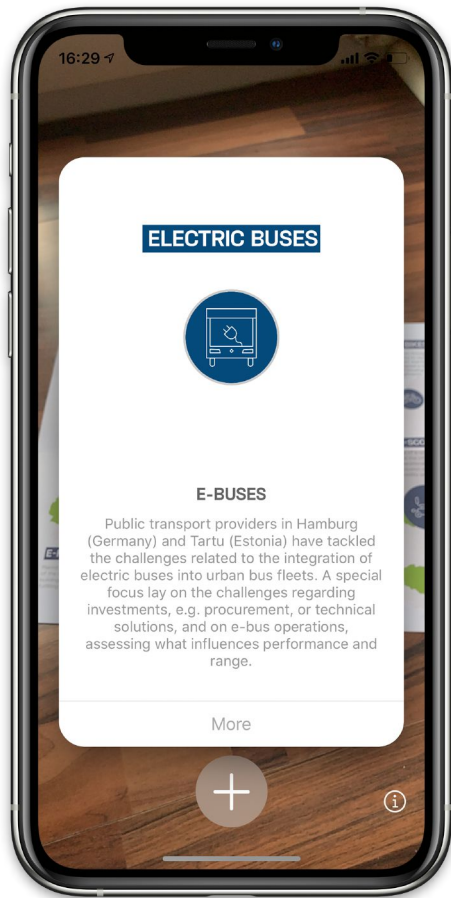

By tapping on a blue icon, information about the project is displayed in a pop-up. A click on the More-button leads to the respective website of the project.



Complete visualization of the virtual map with all 3D objects.



Display of the respective website in the App.



Push on the Info button to get to this page.